



Howard Morley  
& Sons

PER MONTH

**£6,750 Per Month**

**Burrows Lane**

Guildford, GU5 9QF





Approximate Gross Internal Floor Area = 188.0 sq m / 2024 sq ft

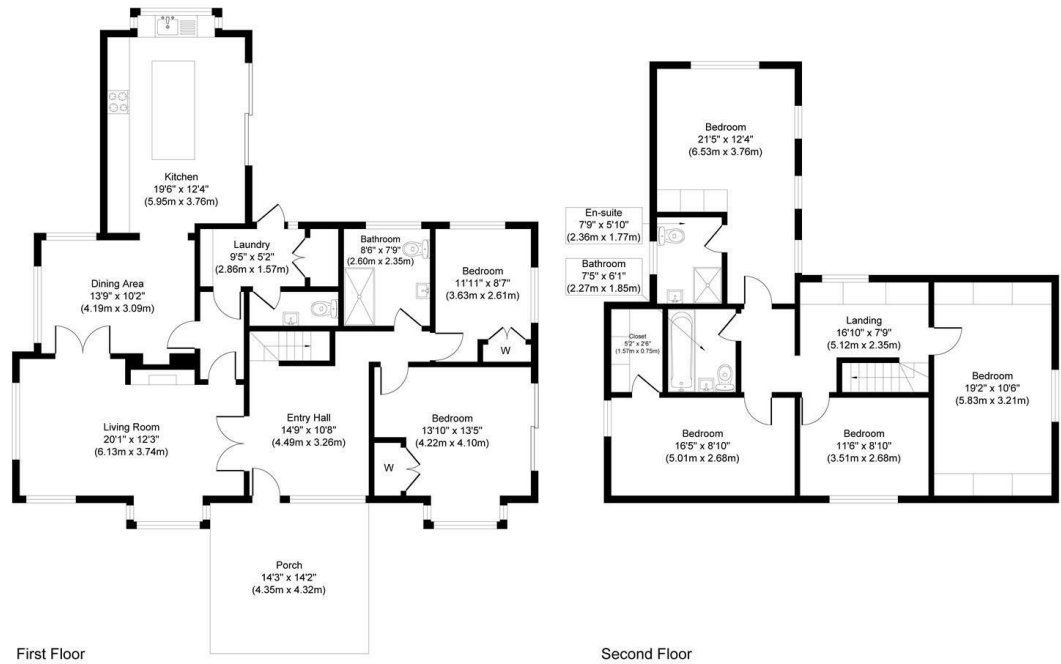

6

3

2

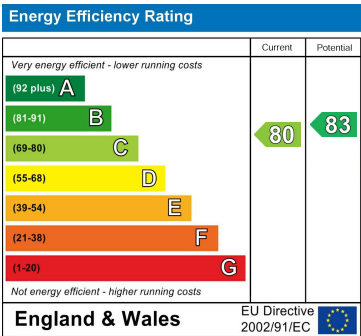

Agents Note: Whilst every care has been taken to prepare these particulars, they are for guidance purposes only. All measurements are approximate and are for general guidance purposes only and whilst every care has been taken to ensure their accuracy, they should not be relied upon and potential buyers/tenants are advised to recheck the measurements

Howard Morley & Sons

OFFICE ADDRESS

276 High Street

Guildford

Surrey

GU1 3JL

OFFICE DETAILS

01483 575 304

lettings@hmorley.co.uk

hmorley.co.uk